

Disney  
TIM BURTON'S  
THE NIGHTMARE BEFORE CHRISTMAS  
REFRESH

## Festival Quilt (Q-022B)

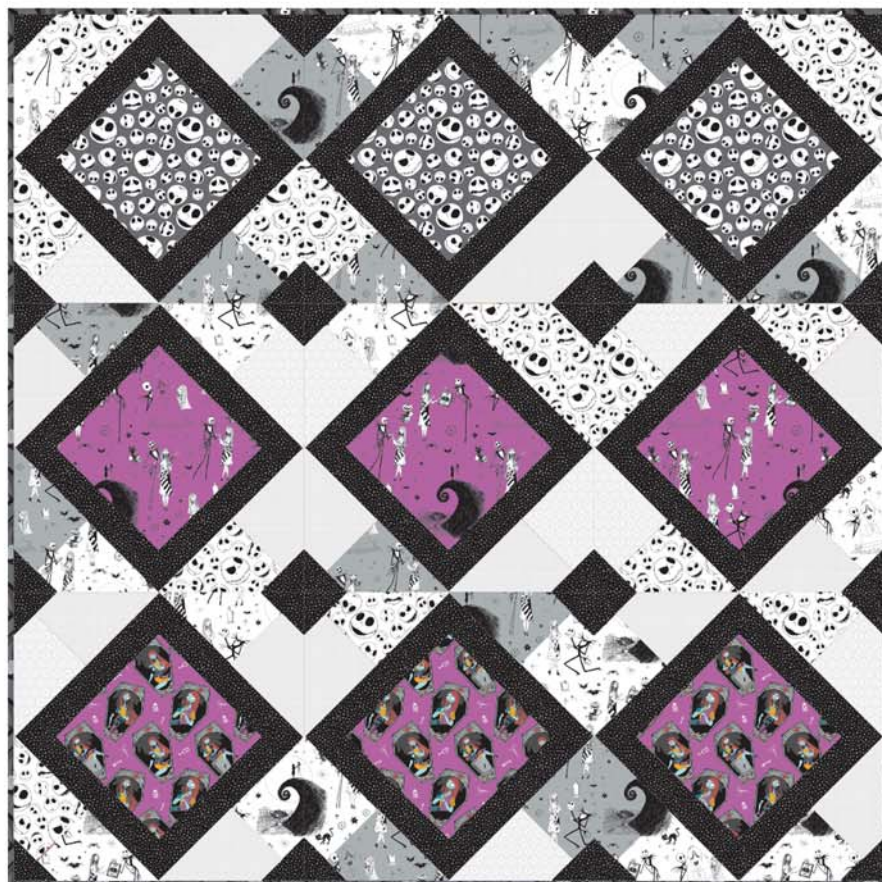

### Fabric requirements



Fabric A  
2141-0002  
1-1/4 yards



Fabric B  
85390104 #3  
1/3 yard



Fabric C  
85390105 #4  
1/3 yard



Fabric D  
85390103 #4  
1/3 yard



Fabric E  
85390104 #1  
1/2 yard



Fabric F  
85390105 #1  
1/2 yard



Fabric G  
85390105 #3  
1/2 yard



Fabric H  
2143-0001  
1/2 yard



Fabric I  
2142-0001  
1/3 yard



Binding  
85390102 #1  
1/2 yard

Exclusive Quilt Design by Anne Sullivan of Play Crafts for Camelot Fabrics  
Fabric collection: The Nightmare Before Christmas Refresh by Camelot Design Studio from Camelot Fabrics. © Disney  
The direction of the fabrics in the digital imagery may not be accurate to the final product.



Suggested Backing  
2141-0044  
4 yards



Blog, Facebook, Twitter @CamelotFabrics  
Pinterest, YouTube & Instagram @Camelot\_Fabrics  
camelotfabrics.com • camelotfabricsblog.com  
Toll-Free: 1-800-361-4120 • 514-382-2400  
info@camelotfabrics.com • www.camelotfabrics.com

Finished Quilt Size: 60" x 60"

## OTHER TOOLS & SUPPLIES

- Rotary cutter & mat
- Sewing machine & coordinating thread
- Iron & pressing surface
- Pencil
- 2 yds extra-wide quilt batting (at least 64" wide)

## NOTES

- For best results read through all the instructions before starting.
- Please wash, dry & iron your fabric before beginning, and trim selvages.
- Unless otherwise directed, sew all seams with a scant 1/4" allowance and the fabrics' Right Sides together, and press seams open as you go.
- WOF = Width of Fabric

## CUTTING

### Fabric A

Cut (12) 2-1/2" x WOF strips:

Sub-cut (18) 2-1/2" x 14-1/2" rectangles & (18) 2-1/2" x 10-1/2" rectangles.

Cut (2) 4" x WOF strips:

Sub-cut (20) 4" squares - sub-cut each square corner-to-corner to yield (40) triangles.

Cut (1) 10-1/2" strip:

Sub-cut (3) 10-1/2" squares.



Cut (2) 8" X WOF strips:

Sub-cut (10) 7-1/2" x 8" rectangles.



### Fabric I

Cut (1) 8" x WOF strip:

Sub-cut (5) 7-1/2" x 8" rectangles.

## Binding

Cut (6) 2-1/2" x WOF strips.

## Backing

Cut (2) 72" x WOF rectangles.



## FOCAL SQUARE BLOCKS



1. Sew a 2-1/2" x 10-1/2" Fabric A rectangle to the top- and bottom edges of each 10-1/2" Fabric B-C-D square.

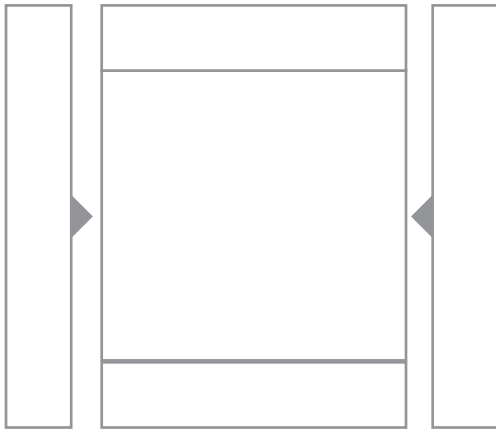

2. Sew a 2-1/2" x 14-1/2" Fabric A rectangle to the left- and right-hand edges of each of the resulting units.

3. Join (40) of your 7-1/2" x 8" Fabric E - I squares at their 7-1/2" edges to make a long strip as shown. We're showing the row in (3) parts for spacial considerations, but yours should be one continuous strip.

Note: be sure to join the rectangles at the 7-1/2" edges, *not* the 8" edges. This will give you a series of 7-1/2" squares, because of the seam allowance.

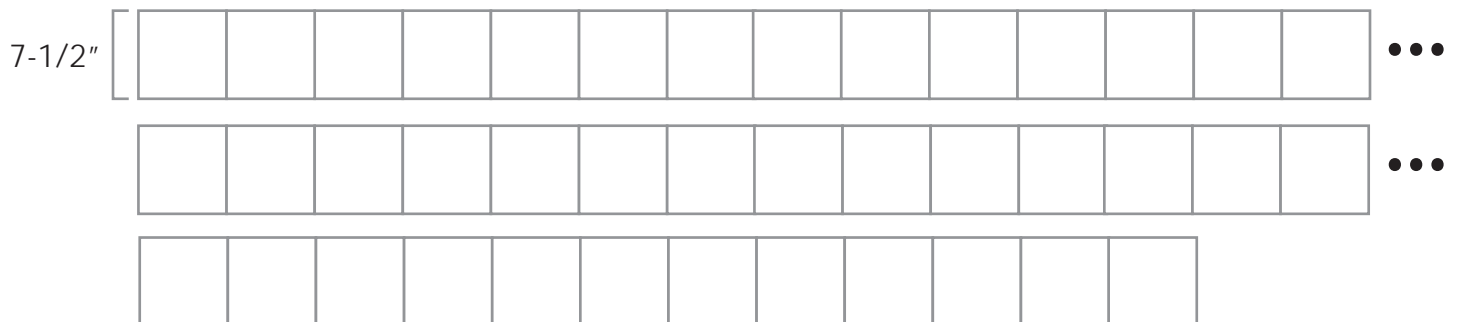

4. Cut along the 45° angle between the seams of each square, making (39) HST sets as shown.

Note: because the first & last rectangles of the strip are not quite square, you should use a 45° angle tool lined up with the seams to cut these pieces.

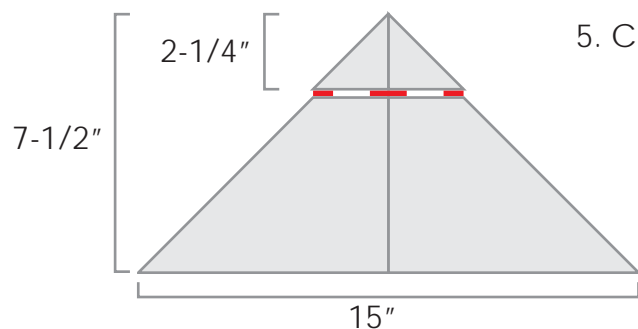
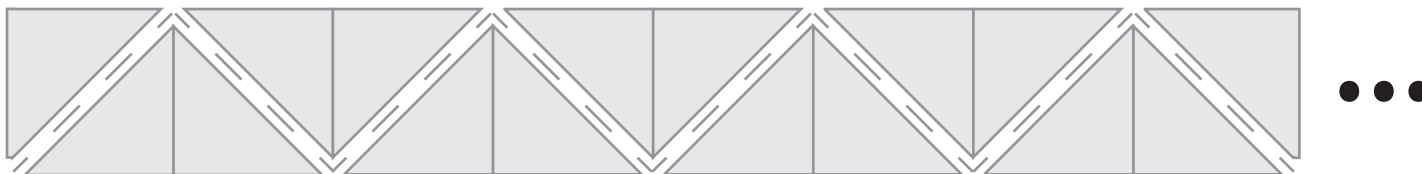

5. Cut 2-1/4" from the tip of each triangle set.

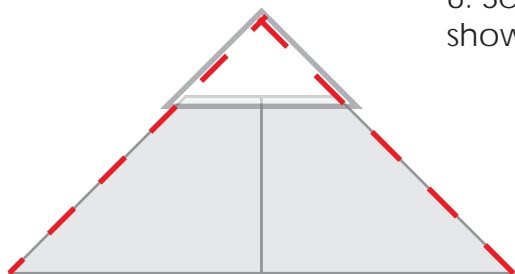

6. Sew a Fabric A triangle to the tip of each HST set as shown, and trim edges.

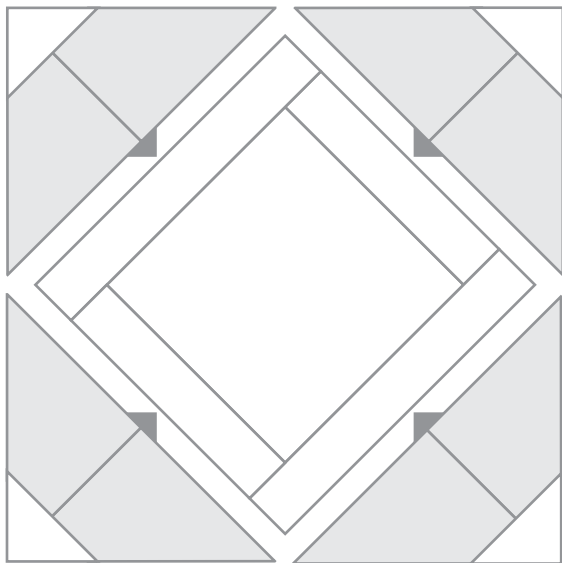

7. Sew (4) of the HST units created in Step 6 to the (4) edges of each bordered square from Step 2 as shown. Please refer to the quilt illustration on Page 1 for the arrangement of HST units & squares.

You'll have some leftover corners - this is fine.

8. Trim each block to 20-1/2" square, or slightly smaller if your seam allowance resulted in smaller blocks. The important thing is that all blocks be the same size.

## MAKING THE QUILT TOP

1. Sew the Blocks in (3) rows of (3) blocks as shown, again referring to Page 1 for block order.

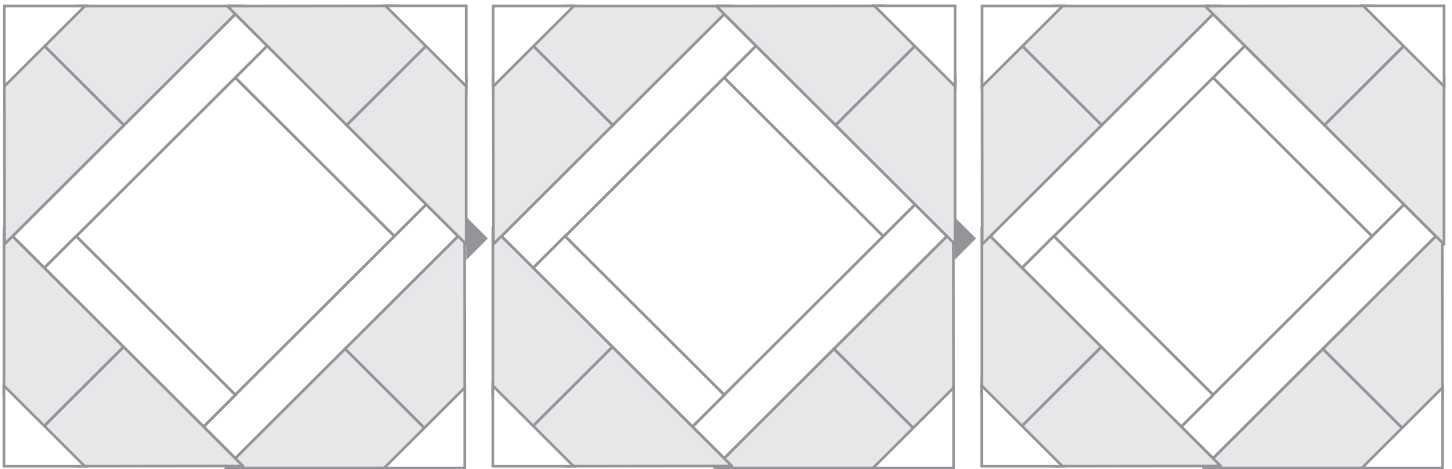

2. Sew the rows together to complete the Quilt Top.

## FINISHING THE QUILT

1. Join the (2) Backing rectangles along their 72" edges. Trim to square, if desired.
2. Layer the Quilt Top & Backing, Right Sides out, with a layer of batting between them. Baste & quilt as desired.
3. Join the Binding strips end-to-end, press into a long strip of double-fold binding, and bind your quilt.